

MCAF1500-MCAF2000-MCAF2500



MCAF1500

www.infrico.com
info@infrico.com

Ctra. de Aguilar A-318 por Moriles Km. 15,5 – A-3132 - 14900, Lucena (Córdoba)

Características técnicas y constructivas sujetas a variación sin previo aviso
We reserve the right to change specifications without prior notice
Les caractéristiques techniques et la conception peuvent être sujettes à modifications, sans préavis



Rev: 01 Fecha/Date: 16/09/2019 FT_MCAF1500_00_ES_EN_FR_19_01
FT_MCAF2000_00_ES_EN_FR_19_01
FT_MCAF2500_00_ES_EN_FR_19_01

MCAF1500-MCAF2000-MCAF2500

ALZADO/ ELEVATION/ VUE LATÉRAL

PLANTA/PLAN VIEW/DESSUS/VUE DE PROFIL

PERFIL / RIGHT VIEW / VUE EN PLAN

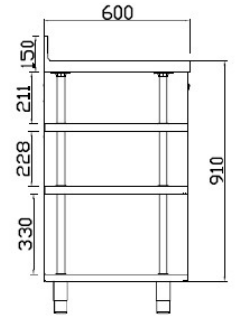
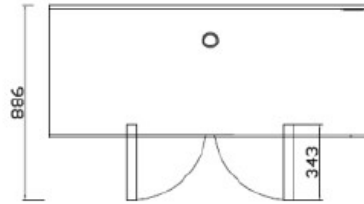
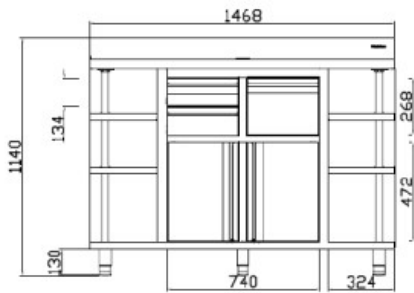

MCAF1500

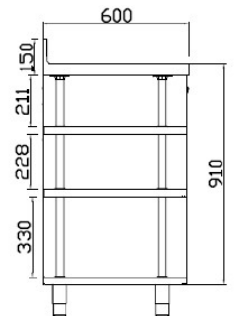
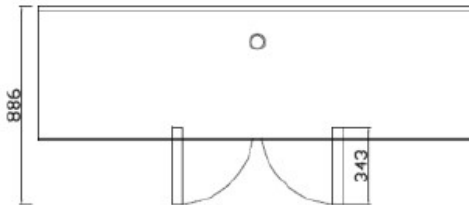
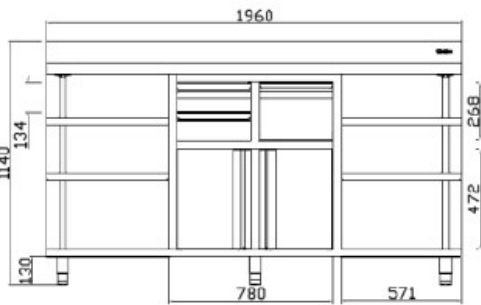

MCAF2000

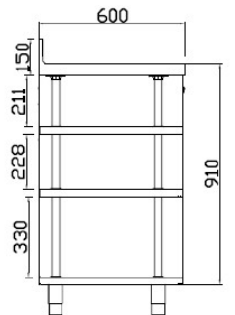
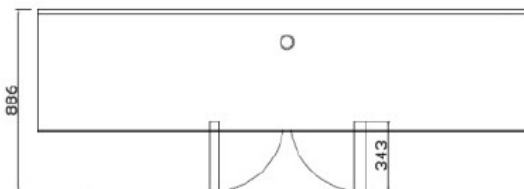
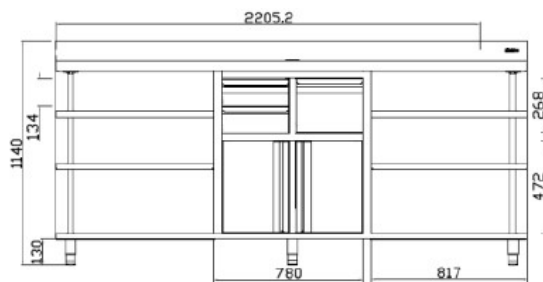

MCAF2500

www.infrico.com
info@infrico.com

Ctra. de Aguilar A-318 por Moriles Km. 15,5 – A-3132 - 14900, Lucena (Córdoba)

Características técnicas y constructivas sujetas a variación sin previo aviso
 We reserve the right to change specifications without prior notice
 Les caractéristiques techniques et la conception peuvent être sujettes à modifications, sans préavis

