

1160



117712

Bartscher GmbH
Franz-Kleine-Str. 28
D-33154 Salzkotten
Germany

Phone: +49 5258 971-0
Fax: +49 5258 971-120
Service hotline: +49 5258 971-197
www.bartscher.com



Version: 2.0

Date of preparation: **2024-11-04**

Original instruction manual

| | | |
|-----|---|----|
| 1 | Safety | 2 |
| 1.1 | Explanation of Signal Words | 2 |
| 1.2 | Safety instructions | 3 |
| 1.3 | Intended Use | 6 |
| 1.4 | Unintended Use | 6 |
| 2 | General information | 7 |
| 2.1 | Liability and Warranty | 7 |
| 2.2 | Copyright Protection | 7 |
| 2.3 | Declaration of Conformity | 7 |
| 3 | Transport, Packaging and Storage | 8 |
| 3.1 | Delivery Check | 8 |
| 3.2 | Packaging | 8 |
| 3.3 | Storage | 8 |
| 4 | Technical Data | 9 |
| 4.1 | Technical Specifications | 9 |
| 4.2 | List of Components of the Appliance | 10 |
| 4.3 | Functions of the Appliance | 11 |
| 5 | Installation and operation | 11 |
| 5.1 | Installation | 11 |
| 5.2 | Operation | 13 |
| 6 | Cleaning and Maintenance | 18 |
| 6.1 | Safety Instructions for Cleaning | 19 |
| 6.2 | Cleaning | 19 |
| 7 | Possible Malfunctions | 19 |
| 8 | Disposal | 20 |



Read these instruction manual before using the appliance and keep it available at all times!

This instruction manual contains information about installation, operation and maintenance of the appliance and constitutes an important source of information and reference guide. The knowledge of all operational and safety instructions included in this manual is a prerequisite for safe and proper handling of the appliance.

Read this instruction manual before you use the appliance and particularly before you start the appliance to prevent injury or damage. Incorrect use may cause damage.

All important information contained in the operating instructions must be available to the appropriate staff at all time. The operator shall be responsible for their availability.

In addition to the operating instructions, you must comply with the general, legal and other applicable regulations for occupational safety and environmental protection.

EN

1 Safety

This appliance has been manufactured in accordance with technical standards currently in force. However, the appliance may be a source of hazards if used improperly or contrary to its intended purpose. All persons using the appliance must consider information included in this instruction manual and observe safety instructions.

1.1 Explanation of Signal Words

Important safety instructions and warning information are indicated in this instruction manual with appropriate signal words. You must strictly follow the instructions, to prevent accidents, personal injuries and property damages.



DANGER!

The signal word **DANGER** warns against hazards that lead to severe injuries or death if the hazards are not avoided.



WARNING!

The signal word **WARNING** warns against hazards that may lead to moderate or severe injuries or death if the hazards are not avoided.



CAUTION!

The signal word **CAUTION** warns against hazards that may lead to light or moderate injuries if the hazards are not avoided.

IMPORTANT!

The signal word **IMPORTANT** indicates possible property damages, which may occur if safety instructions are not observed.

NOTE!

The symbol **NOTE** indicates subsequent information and guidelines for the user on usage of the appliance.

1.2 Safety instructions

Electrical Current

- Too high a mains voltage or incorrect installation may cause electric shock.
- The appliance may be connected only if data on the rating plate correspond with the mains voltage.
- To avoid short-circuit, the appliance should be kept dry.
- If there are malfunctions during operation, disconnect the appliance from the power supply.
- Do not touch the appliance's plug with wet hands.
- Never take hold of the appliance if it has fallen into water. Immediately disconnect the appliance from the power supply.
- Any repairs or housing opening may be carried out by professionals and relevant workshops only.
- Do not transport the appliance, holding it by the power cord.
- Do not allow the power cord to come into contact with heat sources or sharp edges.
- Do not bend, pinch nor knot the power cord.

- Always completely unwind the power cord.
- Never place the appliance or other objects on the power cord.
- Always take hold of the plug to disconnect the appliance from the power supply.
- Check the power cord regularly for damage. Do not use the appliance if the power cord is damaged. If this cable is damaged, it must be replaced by customer service or a qualified electrician in order to avoid dangers.

Flammable Materials

- Never subject the appliance to contact with high temperature sources, e.g.: oven, furnace, open flame, heat generating devices, etc.
- To avoid fire hazard, clean the appliance regularly.
- Do not cover the appliance with, e.g., aluminium foil or cloths.
- Use the appliance only with materials designated to this end and with correct temperature settings. Materials, groceries and left-overs remaining in the appliance may catch fire.
- Never use the appliance near flammable or inflammable materials, e.g.: petrol, spirit, alcohol, etc. High temperature triggers evaporation of these materials, and, as a result of contact with sources of ignition, an explosion may occur.
- In case of fire, disconnect the appliance from the power supply before attempting suitable fire-extinguishing actions.
- Never attempt to extinguish fire with water if the appliance is connected to the power supply. Following extinction of fire, ensure sufficient fresh air inflow.

Hot Surfaces

- Surfaces of the appliance become hot during operation. Burning hazard! High temperature remains for some time after switching the appliance off.
- Do not touch any hot surfaces of the appliance. Use the provided handling elements and holders.
- You may transport and clean the appliance after it cools down entirely.
- It is prohibited to sprinkle hot surfaces with cold water or flammable liquids.

Operator's responsibility

The operator is responsible for complying with the currently applicable laws, regulations, ordinances and existing national regulations on accident prevention, environmental protection, as well as the internal operation, operating and safety instructions that apply at the respective installation site.

Obligations of the operator:

- Operate the appliance and its components only in a technical condition that does not raise any objections, with functional protective and safety elements.
- Prepare risk assessment at work positions.
- Provide instruction and regular staff training. Pay special attention to and observe the section concerning safety and any safety hints.
- Provide suitable personal protective equipment (PPE)
- Observe the intervals of maintenance and cleaning.
- Document training/instructions, replacement of components.

Operating Personnel

- The appliance may only be operated by qualified personnel and trained specialist personnel.
- This appliance may not be operated by persons (including children) with limited physical, sensory or mental capabilities, nor by persons with limited experience and/or limited knowledge.
- Children should be supervised to ensure that they are not playing with or switching on the appliance.

EN

Supervised Usage only

- Only supervised appliance may be used.
- Always remain in an immediate vicinity of the appliance.

Improper Use

- Unintended or prohibited use may cause damage to the appliance.
- The appliance may only be used when its technical condition is flawless and allows for safe operation.
- The appliance may only be used when all connections are executed according to rules of law in force.
- The appliance may only be used when it is clean.
- Use only original spare parts. Never attempt to repair the appliance on your own.
- Do not introduce any changes in the appliance nor modify it.

1.3 Intended Use

This appliance is only intended for use described in the operating instructions, with the supplied and approved components.

Any other use is considered against the intended purpose. The manufacturer shall not be liable for any damage due to unintended use. In such cases the responsible party shall only be the user/operator.

The following is an intended purpose:

- Smoking of suitable foods in a combi-steamer.

1.4 Unintended Use

An unintended use may lead to personal injuries or property damages caused by hazardous voltage, fire or high temperature. The appliance may only be used to perform tasks described in this instruction manual.

The following is an unintended use:

- Smoking of unsuitable food products.

2 General information

2.1 Liability and Warranty

The appliance was built in accordance with the current state of the art and recognized technical safety principles. Nevertheless, during its use, there may be a threat to the health and life of the user or bystanders, or the danger of damage to the device or other assets. Warranty and liability claims for personal injury/property damage as well as defects at work are excluded if they can be attributed to one or more of the following causes:

- Use against the intended purpose
- Failure to follow/disregard the instructions and all related information
- Unauthorized structural or technical changes to the device
- Engaging insufficiently trained and insufficiently qualified personnel
- Operation with defective or incorrectly installed safety and protective devices
- Inadequate maintenance or cleaning
- Faults not fixed
- Use of prohibited media, cleaning agents, etc.
- Use of unauthorised spare parts
- Errors in operation or other misuse
- Disasters caused by foreign objects or force majeure
- Destruction of the type plate and stickers relevant for operation and safety

EN

2.2 Copyright Protection

This instruction manual, and texts, drawings and images included in it, as well as its other components are copyright protected. It is prohibited to reproduce this instruction manual (including its excerpts), in any form and by any means, and to use and/or transfer its content to third parties without manufacturer's written permission. Violation of the above results in obligation to pay compensation. We reserve the right to claim further damages.

2.3 Declaration of Conformity

The appliance meets the currently applicable standards and guidelines of the European Union. We confirm the above in the EC Declaration of Conformity. We may provide relevant Declaration of Conformity upon request.

3 Transport, Packaging and Storage

3.1 Delivery Check

Immediately upon reception, check the delivery for completeness and possible shipping damage. In the case of visible transport damage refuse to accept the appliance or accept it conditionally. Mark and note the scope of damage in shipping documents/consignment list of the shipping company and lodge a complaint. Concealed damage must be reported immediately upon its discovery, as compensation claims may only be filed within applicable time limits.

If you find that parts or accessories missing, please contact our Customer Service Department.

3.2 Packaging

Do not dispose of the appliance cardboard box. It may be used to store the appliance when relocating or when shipping the appliance to our service point in the case of any damages.

The packaging and its elements are made of recyclable materials. Particularly, these are: plastic films and bags, cardboard box.

When disposing of the packaging, observe applicable domestic regulations. Recyclable packaging materials should be recycled.

3.3 Storage

Leave the packaging closed until installation of the appliance; observe external indications concerning method of placing and storage. Store the packaging in the following conditions only:

- in closed rooms;
- in dry and dust-free surrounding;
- away from aggressive agents;
- in a location protected against sunlight;
- in a location protected against mechanical shocks.

In the case of extended storage (over three months), make sure you check the condition of the packaging and the parts regularly. If needed, replace the packaging with a new one.

4 Technical Data

4.1 Technical Specifications

| | |
|---|---------------------------|
| Name: | Smoker-Box 1160 |
| Art. No.: | 117712 |
| Material: | stainless steel |
| Version: | with heating coil |
| Volume, in litres | 1,16 |
| Smoker-Box dimensions (W x D x H), in mm: | 125 x 470 x 75 |
| Max. smoking temperature, in °C: | 200 |
| Connected load: | 0,2 kW 230 V 50-60 Hz |
| Dimensions (W x D x H), in mm: | 130 x 470 x 75 |
| Weight, in kg: | 6,6 |

We reserve the right to implement technical modifications.

EN

Version / Characteristics

- Designed for: combi-steamers
- Consists of:
 - mains adapter
 - Smoker-Box
- Suitable fuel: standard smoking materials
- ON/OFF switch
- Indicator light:
 - ready for operation
 - heating

4.2 List of Components of the Appliance

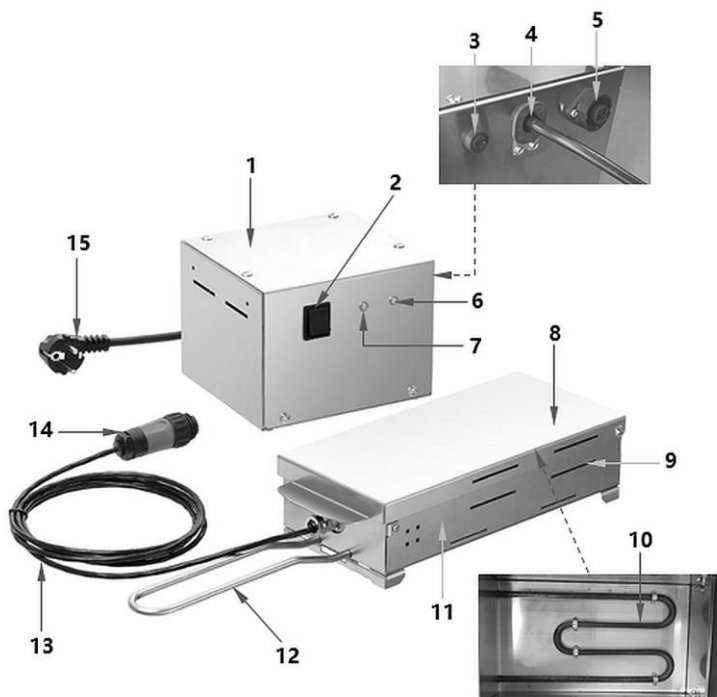

Fig. 1

- | | |
|--------------------------------|-------------------------------|
| 1. Mains adapter | 2. ON/OFF switch |
| 3. Fuse | 4. Cord connection |
| 5. Plug connection | 6. Orange LED indicator light |
| 7. Green LED indicator light | 8. Smoker-Box lid |
| 9. Ventilation openings | 10. Heating coil |
| 11. Smoker-Box housing | 12. Smoker-Box handle |
| 13. Connection cable | 14. Plug |
| 15. Power cord with mains plug | |

4.3 Functions of the Appliance

Smoking aromas give a unique flavour to meat, fish and also vegetables. With the Smoker-Box, dishes get this amazing flavour right from the cooking stage. The simple handling speaks for itself: just connect the Smoker-Box to the power supply and you are ready to start smoking in a combi-steamer.

5 Installation and operation



CAUTION!

Incorrect installation, positioning, operation, maintenance or misuse of the appliance may lead to personal injury or property damage.

Positioning and installation, as well as repairs may be performed by authorised technical service only and in compliance with the applicable national law.

NOTE!

The manufacturer disclaims all liability and provides no warranty for damages, which may be attributed to non-observance of regulations or incorrect installation.

EN

5.1 Installation

Unpacking / Positioning

- Unpack the appliance, remove all external and internal packaging elements and shipment safeguards.



CAUTION!

Choking hazard!

Prevent children from accessing packaging materials, for instance: plastic bags and EPS elements.

- If the appliance is covered with a protective film, remove it. Remove the film slowly, so no glue residues are left. Remove any glue residues with the use of a suitable solvent.
- Be careful not to damage the rating plate and warning labels affixed to the appliance.

- **Never** place the appliance in humid or wet environment.
- Place the appliance in a way making the connections easily accessible, so that they may be quickly disconnected if such a need arises.
- When selecting the installation site, please consider the following items:
 - The mounting surface must be even, sufficiently load-bearing, waterproof, dry and resistant to high temperatures.
 - Make sure that the designated escape routes are clear.
 - Ensure a stable position.
 - Allow sufficient space for work, maintenance and cleaning.
 - Leave the supply and exhaust air vents, if any, free.
 - Comply with applicable technical and building regulations.
- Maintain sufficient clearance from table edges. The appliance might turn over and fall down.

Power supply connection

- Verify if technical data of the appliance (see rating plate) correspond with the local electric power grid specification.
- Connect the appliance to a single, properly grounded mains socket with protective contact. Do not connect the appliance to a multi-socket.
- The power cord should be laid in a way preventing anyone from threading on it or tripping against it.

5.2 Operation



WARNING

Risk of burning!

The Smoker-Box becomes very hot during operation and remains hot for some time after removal and switching off.

Do not touch the appliance during operation nor immediately after switching it off.

Be very careful when removing the Smoker-Box. Use heat-resistant gloves.

Fire hazard!

Wood chips or leftover pellets can be very hot.

Make sure that wood chips or pellets do not come into contact with flammable or combustible materials or liquids.

Preparation of the Appliance

1. Before starting up, clean the appliance and equipment according to instructions in section '**Cleaning**'.
2. Dry the appliance.

Filling the Smoker-Box



Fig. 2



Fig. 3

1. Open the Smoker-Box by lifting the lid upwards.
2. Fill the Smoker-Box with sufficient wood chips.

WARNING!

Use natural, unprocessed products only, such as wood chips or suitable pellets that are not harmful to health.

EN

Connecting Mains Adapter to Smoker-Box

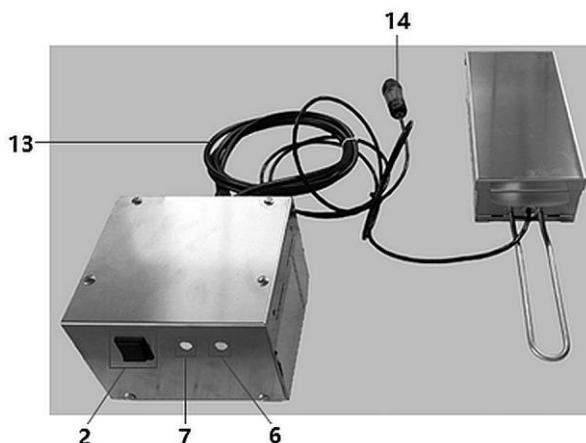

Fig. 4

1. Connect the Smoker-Box to the mains adapter using the connection cable (13) and plug (14) (Fig. 4).
2. Plug the mains adapter into a suitable single socket.

When the mains adapter is plugged in, the green LED indicator light (7) will illuminate.

Placing Smoker-Box in Combi-Steamer

NOTE!

We recommend that you use the Smoker-Box only in models with the automatic cleaning function.



Fig. 5

EN

1. Insert the Smoker-Box into the cooking chamber of the combi-steamer in the order listed below:
 - place the Smoker-Box on a baking tray,
 - place the baking tray with the Smoker-Box on the top shelf to avoid cooking liquids dripping down onto the Smoker-Box,
 - route the connection cable between the combi-steamer seal and the inner door glass of the combi-steamer.

ATTENTION!

The connection cable can become deformed or damaged if it is not placed correctly.

Route the connection cable between the inner door glass of the combi-steamer and the combi-steamer door seal, away from the condensation drip tray in the combi-steamer door.

In case the connection cable is damaged, do not use the combi-steamer and contact the service company.

Setting Combi-Steamer for Smoking Cycle

Introduce the following combi-steamer settings for the smoking mode:

Preparation type: Circulating air

Temperature: max. 200°C

Fume extractor: closed

Fan speed: max. 3

If the temperature is set below 90°C, the fan speed must be set between 1 and 2.

NOTE!

Follow the instructions in the combi-steamer user manual to set the smoking mode.

ATTENTION!

Too high temperatures in the combi-steamer may lead to damage of the connection pipe.

During smoking cycle, never set the temperature in the combi-steamer higher than 200°C.

EN

Appliance Start-Up

1. To switch the Smoker-Box on, press the ON/OFF switch (2, Fig. 4).

The orange LED indicator light (3) lights up and the Smoker-Box is heated.

After approx. 10–15 minutes, depending on the wood used, smoke starts to be generated.

End of Smoking Cycle

1. When the smoking cycle is complete, switch the Smoker-Box off using the mains adapter.
2. Carefully remove the Smoker-Box from the combi-steamer using heat-resistant gloves.
3. Disconnect the mains adapter from the mains supply and the Smoker-Box from the mains supply.
4. When the Smoker-Box has cooled down, empty it.

Recommendations for Smoking

Depending on the food to be smoked, different types of wood are used. Both dry wood and wood that has been soaked in water for a short time (10–20 minutes) can be used.

| Type of wood | Properties | Recommended food |
|----------------|---|---|
| ALDER | Very delicate, slightly sweet | Fish, pork, chicken, white poultry meat |
| ALMOND TREE | Sweet | All types of meat |
| APPLE TREE | Light, specific aftertaste | Fish and red meat |
| ASH | Aftertaste similar to maple | Pork and poultry |
| BEECH | Considered the best wood for smoking | Poultry, pork and beef |
| CHERRY TREE | Acidic, strongly smoky. Juicy and fruity | Poultry, pork and beef |
| GRAPEVINE WOOD | Acidic, juicy and fruity | Poultry, red meat, lamb |
| BLACK WALNUT | Sweet and strong, with a bacon aftertaste | Pork, ham and beef |
| LILAC | Very light, slightly floral aftertaste | Shellfish, seafood and lamb |
| MAPLE | Delicate and slightly sweet | Pork, poultry, small game and cheeses |
| LEGUME | Strong aftertaste | Beef, fish, poultry and game |
| MULBERRY | Sweet aroma, reminiscent of apple | Shellfish, poultry and lamb |

| Type of wood | Properties | Recommended food |
|---------------|-----------------------------------|--------------------------------------|
| OAK | Strong aftertaste | Pork, red meat, fish and coarse game |
| WHISKY OAK | Whisky aftertaste | Pork, red meat, fish and coarse game |
| ORANGE TREE | Light aftertaste | Beef, pork, fish and poultry |
| PEAR TREE | Very light | Poultry and pork |
| PECAN | Sweet and light | Poultry, beef, pork and cheese |
| PLUM TREE | Delicate aroma. | Optimal for white and pink meat |
| COMMON WALNUT | Heavy smoke, use with other woods | Pink meat and game |

Hot and Cold Smoking

You can smoke both in cold and hot mode, depending on the product and the desired effect. Hot smoking means: smoking and heat treatment. For this purpose, the combi-steamer can be set to heat treatment in Delta-T mode or to a constant temperature.

For cold smoking, such as smoked salmon, it is advisable to place a baking tray with ice on the lowest shelf of the combi-steamer to keep the temperature down.

6 Cleaning and Maintenance

The operator must ensure that the device and its safety components are kept in good condition. Control and safety systems should be checked for their effectiveness.

Maintenance, cleaning and repairs must only be carried out by suitably trained and specialised personnel.

If the safety devices need to be removed for maintenance, cleaning and repair, they should be reinstalled immediately after completion and their function should be checked.

All maintenance and cleaning work must be carried out in accordance with the operating instructions at the specified intervals.

6.1 Safety Instructions for Cleaning

- Before cleaning, disconnect the appliance from the power supply.
- Leave the appliance to cool down completely.
- Make sure water does not enter the appliance. Do not immerse the appliance in water or other liquids during cleaning. Do not clean the appliance with a pressurized water jet.
- Do not use any sharp or pointed, nor metal implements (knife, fork, etc.). Sharp or pointed implements may damage the appliance, and when in contact with live parts, they may cause electric shock.
- For cleaning, do not use any scouring agents that contain solvents nor corrosive cleaning agents. They may damage the surface.

6.2 Cleaning

1. For hygienic reasons and to avoid malfunctions, clean the appliance regularly at the end of the working day.
2. Clean the Smoker-Box with warm water, mild washing agent and soft cloth or sponge.

ATTENTION!

Never use steel wool, steel brushes nor steel spatulas to clean the Smoker-Box so as not to damage the surface.

3. Wipe the outside surfaces of the Smoker-Box and the mains adapter, as well as the connection cable, with a slightly damp cloth only.
4. Dry all cleaned surfaces with a soft cloth.

7 Possible Malfunctions

The table below contains descriptions of possible causes and solutions to malfunctions or errors during operation of the appliance. The works may only be performed by suitably qualified technical personnel.

When malfunction cannot be removed, contact the technical service. In such a case, provide article number, model and serial number. You will find this information on the rating plate.

| Problem | Possible Cause | Solution |
|--|---|---|
| Smoker-Box does not heat up, although the orange LED indicator light on the mains adapter is on. | Plug is not inserted | Insert the plug into a suitable mains socket |
| | The fuse at the back of the mains adapter has blown | Disconnect the connector and check the fuse (3, Fig. 1) at the back of the mains adapter; if necessary, reset it with a screwdriver If the problem persists, contact the service company |

8 Disposal

Electrical Appliance



Electric appliances are marked with this symbol. Electrical appliances must be disposed of and recycled in a correct and environmentally friendly manner. You must not dispose of electric appliances with household waste. Disconnect the appliance from the power supply and remove power cord from the appliance.

Electrical appliances should be returned to designated collection points.