



## Silversteam2



**116119**

Bartscher GmbH  
Franz-Kleine-Str. 28  
D-33154 Salzkotten  
Germany

Phone: +49 5258 971-0

Fax: +49 5258 971-120

**Technical Support Hotline:** +49 5258 971-197

[www.bartscher.com](http://www.bartscher.com)



Version: 1.0

Date of preparation: 2024-12-06

---

## Original instruction manual

1	Safety .....	2
1.1	Explanation of Signal Words .....	2
1.2	Safety instructions .....	3
1.3	Intended Use .....	5
1.4	Unintended Use .....	5
2	General information .....	6
2.1	Liability and Warranty .....	6
2.2	Copyright Protection .....	6
2.3	Declaration of Conformity .....	6
3	Transport, Packaging and Storage .....	7
3.1	Delivery Check .....	7
3.2	Packaging .....	7
3.3	Storage .....	7
4	Technical Data .....	8
4.1	Technical Specifications .....	8
4.2	List of Components of the Appliance .....	9
4.3	Functions of the Appliance .....	9
5	Installation and operation .....	10
5.1	Installation .....	10
5.2	Operation .....	14
6	Cleaning and Maintenance .....	15
6.1	Safety Instructions for Cleaning .....	16
6.2	Cleaning .....	16
6.3	Maintenance .....	18
7	Disposal .....	18



**Read these instruction manual before using the appliance and keep it available at all times!**

This instruction manual contains information about installation, operation and maintenance of the appliance and constitutes an important source of information and reference guide. The knowledge of all operational and safety instructions included in this manual is a prerequisite for safe and proper handling of the appliance.

Read this instruction manual before you use the appliance and particularly before you start the appliance to prevent injury or damage. Incorrect use may cause damage.

All important information contained in the operating instructions must be available to the appropriate staff at all time. The operator shall be responsible for their availability.

In addition to the operating instructions, you must comply with the general, legal and other applicable regulations for occupational safety and environmental protection.

EN

## 1 Safety

This appliance has been manufactured in accordance with technical standards currently in force. However, the appliance may be a source of hazards if used improperly or contrary to its intended purpose. All persons using the appliance must consider information included in this instruction manual and observe safety instructions.

### 1.1 Explanation of Signal Words

Important safety instructions and warning information are indicated in this instruction manual with appropriate signal words. You must strictly follow the instructions, to prevent accidents, personal injuries and property damages.



**DANGER!**

The signal word **DANGER** warns against hazards that lead to severe injuries or death if the hazards are not avoided.



### **WARNING!**

The signal word **WARNING** warns against hazards that may lead to moderate or severe injuries or death if the hazards are not avoided.



### **CAUTION!**

The signal word **CAUTION** warns against hazards that may lead to light or moderate injuries if the hazards are not avoided.

### **IMPORTANT!**

The signal word **IMPORTANT** indicates possible property damages, which may occur if safety instructions are not observed.

### **NOTE!**

The symbol **NOTE** indicates subsequent information and guidelines for the user on usage of the appliance.

EN

## **1.2 Safety instructions**

### **Electrical Current**

- Too high a mains voltage or incorrect installation may cause electric shock.
- The appliance may be connected only if data on the rating plate correspond with the mains voltage.
- To avoid short-circuit, the appliance should be kept dry.
- If there are malfunctions during operation, disconnect the appliance from the power supply.
- Do not touch the appliance's plug with wet hands.
- Never take hold of the appliance if it has fallen into water. Immediately disconnect the appliance from the power supply.
- Any repairs or housing opening may be carried out by professionals and relevant workshops only.
- Do not transport the appliance, holding it by the power cord.
- Do not allow the power cord to come into contact with heat sources or sharp edges.

- Do not bend, pinch nor knot the power cord.
- Always completely unwind the power cord.
- Never place the appliance or other objects on the power cord.
- Always take hold of the plug to disconnect the appliance from the power supply.
- Check the power cord regularly for damage. Do not use the appliance if the power cord is damaged. If this cable is damaged, it must be replaced by customer service or a qualified electrician in order to avoid dangers.

### Operator's responsibility

The operator is responsible for complying with the currently applicable laws, regulations, ordinances and existing national regulations on accident prevention, environmental protection, as well as the internal operation, operating and safety instructions that apply at the respective installation site.

Obligations of the operator:

- Operate the appliance and its components only in a technical condition that does not raise any objections, with functional protective and safety elements.
- Prepare risk assessment at work positions.
- Provide instruction and regular staff training. Pay special attention to and observe the section concerning safety and any safety hints.
- Provide suitable personal protective equipment (PPE)
- Observe the intervals of maintenance and cleaning.
- Document training/instructions, replacement of components.

### Operating Personnel

- The appliance may only be operated by qualified personnel and trained specialist personnel.
- This appliance may not be operated by persons (including children) with limited physical, sensory or mental capabilities, nor by persons with limited experience and/or limited knowledge.
- Children should be supervised to ensure that they are not playing with or switching on the appliance.

### Improper Use

- Unintended or prohibited use may cause damage to the appliance.
- The appliance may only be used when its technical condition is flawless and allows for safe operation.
- The appliance may only be used when all connections are executed according to rules of law in force.
- The appliance may only be used when it is clean.
- Use only original spare parts. Never attempt to repair the appliance on your own.
- Do not introduce any changes in the appliance nor modify it.

### 1.3 Intended Use

This appliance is only intended for use described in the operating instructions, with the supplied and approved components.

Any other use is considered against the intended purpose. The manufacturer shall not be liable for any damage due to unintended use. In such cases the responsible party shall only be the user/operator.

The following is an intended purpose:

- Venting and exhausting steams and vapours.

EN

### 1.4 Unintended Use

An unintended use may lead to personal injuries or property damages caused by hazardous voltage, fire or high temperature. The appliance may only be used to perform tasks described in this instruction manual.

## 2 General information

### 2.1 Liability and Warranty

The appliance was built in accordance with the current state of the art and recognized technical safety principles. Nevertheless, during its use, there may be a threat to the health and life of the user or bystanders, or the danger of damage to the device or other assets. Warranty and liability claims for personal injury/property damage as well as defects at work are excluded if they can be attributed to one or more of the following causes:

- Use against the intended purpose
- Failure to follow/disregard the instructions and all related information
- Unauthorized structural or technical changes to the device
- Engaging insufficiently trained and insufficiently qualified personnel
- Operation with defective or incorrectly installed safety and protective devices
- Inadequate maintenance or cleaning
- Faults not fixed
- Use of prohibited media, cleaning agents, etc.
- Use of unauthorised spare parts
- Errors in operation or other misuse
- Disasters caused by foreign objects or force majeure
- Destruction of the type plate and stickers relevant for operation and safety

### 2.2 Copyright Protection

This instruction manual, and texts, drawings and images included in it, as well as its other components are copyright protected. It is prohibited to reproduce this instruction manual (including its excerpts), in any form and by any means, and to use and/or transfer its content to third parties without manufacturer's written permission. Violation of the above results in obligation to pay compensation. We reserve the right to claim further damages.

### 2.3 Declaration of Conformity

The appliance meets the currently applicable standards and guidelines of the European Union. We confirm the above in the EC Declaration of Conformity. We may provide relevant Declaration of Conformity upon request.



## **3 Transport, Packaging and Storage**

### **3.1 Delivery Check**

Immediately upon reception, check the delivery for completeness and possible shipping damage. In the case of visible transport damage refuse to accept the appliance or accept it conditionally. Mark and note the scope of damage in shipping documents/consignment list of the shipping company and lodge a complaint. Concealed damage must be reported immediately upon its discovery, as compensation claims may only be filed within applicable time limits.

If you find that parts or accessories missing, please contact our Customer Service Department.

### **3.2 Packaging**

Do not dispose of the appliance cardboard box. It may be used to store the appliance when relocating or when shipping the appliance to our service point in the case of any damages.

The packaging and its elements are made of recyclable materials. Particularly, these are: plastic films and bags, cardboard box.

When disposing of the packaging, observe applicable domestic regulations. Recyclable packaging materials should be recycled.

**EN**

### **3.3 Storage**

Leave the packaging closed until installation of the appliance; observe external indications concerning method of placing and storage. Store the packaging in the following conditions only:

- in closed rooms;
- in dry and dust-free surrounding;
- away from aggressive agents;
- in a location protected against sunlight;
- in a location protected against mechanical shocks.

In the case of extended storage (over three months), make sure you check the condition of the packaging and the parts regularly. If needed, replace the packaging with a new one.

## 4 Technical Data

### 4.1 Technical Specifications

<b>Name:</b>	<b>Condensation hood Silversteam2</b>
Art. No.:	<b>116119</b>
Material:	stainless steel
Number of filters:	2
Filter material:	stainless steel
Number of fan motors/exhaust air outputs:	1
Max. air throughput, in m³/h:	830
Motor output:	383 W
Degree of protection:	IP55
Volume, in dB:	<70
Connected load:	0,38 kW   230 V   50/60 Hz
Dimensions (W x D x H), in mm:	905 x 950 x 300
Weight, in kg:	31,6

We reserve the right to implement technical modifications.

#### Version / characteristics

- Operating mode: exhaust air
- Fan adjustment:
  - control knob
  - manual
  - infinitely variable
- With motor: yes
- ON/OFF switch:
- Mounting type: on top of the appliance
- The set includes:
  - connection material
  - fixation material

## 4.2 List of Components of the Appliance

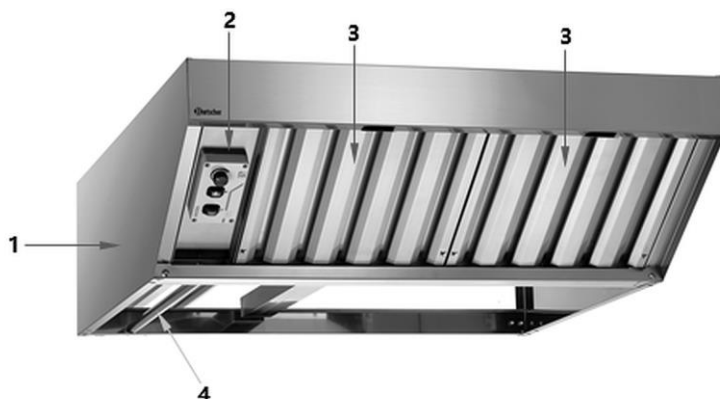

Fig. 1

1. Housing
2. Control elements
3. Filter (2x)
4. Drip tray for condensed water

EN

## 4.3 Functions of the Appliance

When using Silversteam2 series combi steamers with a condensate hood, an exhaust system is not required. Cooking vapours are captured by two filters integrated in the condensate hood.

## 5 Installation and operation

### 5.1 Installation



#### CAUTION!

**Incorrect installation, positioning, operation, maintenance or misuse of the appliance may lead to personal injury or property damage.**

Positioning and installation, as well as repairs may be performed by authorised technical service only and in compliance with the applicable national law.

#### NOTE!

**The manufacturer disclaims all liability and provides no warranty for damages, which may be attributed to non-observance of regulations or incorrect installation.**

EN

### Unpacking

- Unpack the appliance, remove all external and internal packaging elements and transport guards.



#### CAUTION!

#### Choking hazard!

Prevent children from accessing packaging materials, for instance: plastic bags and EPS elements.

- If the appliance is covered with a protective film, remove it. Remove the film slowly, so no glue residues are left. Remove any glue residues with the use of a suitable solvent.
- Be careful not to damage the rating plate and warning labels affixed to the appliance.

### Installation

1. Assemble the appliance in a manner making the connections easily accessible, so that they may be quickly disconnected when required.
2. During installation, make sure ventilation openings are not covered nor blocked.
3. During installation, proceed as follows:



4. Put the condensate hood on the top cover of the combi steamer so that it adheres well to it. Make sure that the supply cable is not blocked between the appliances.
5. Attach the condensate hood to the rear wall of the combi steamer on the right- and left-hand sides using the supplied plates and self-tapping screws.

*Fig. 2*



*Fig. 3*      *Fully assembled condensate hood*

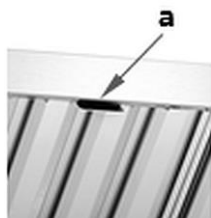

Fig. 4

6. Remove transportation locks (a).

### HINT!

The condensate hood does not require connection to the ventilation system, steam and vapours are condensed by the filter and evacuated through the drip tray for condensate water.

### Connecting to the vapour extraction



Fig. 5

- a There is a spiral hose (a) on the rear wall of the condensate hood.
1. Insert the spiral hose into the vapour extractor (b) of the combi steamer.
- Steam is collected and removed during the operation of the condensate hood.

### Drain connection

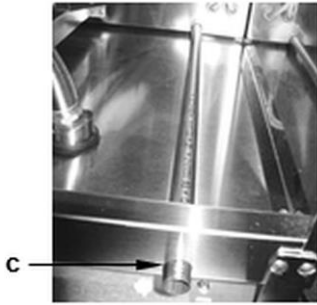

Fig. 6

1. Connect the drain hose (not included) to the drip tray for condensed water (c).

The internal diameter of the hose should be 20 mm.

2. Fix the hose with the use of a clamping band.

### Connection to Electrical Power

- Verify if the technical specification of the appliance (see the rating plate) correspond to the local electricity grid.
- The power cord should be laid in a way preventing anyone from threading on it or tripping against it.
- The appliance is supplied with a connection cable and Schuko power plug.
- It is of utmost necessity to install proper disconnector of all poles upstream of the appliance, so that — when needed — the appliance is quickly disconnected from power supply.
- Moreover, establish a correct grounding connection, according to safety regulations pertaining to electrical installation.

## 5.2 Operation

### Operation principle

The first steam released through the combi steamer door passes through the filter located on the front wall of the condensate hood.

The principle of operation is based on a metal (aluminium) condenser through which the sucked steam is passed.

Temperature difference between the steam (hot) and the aluminium surface (cold) causes the steam to condense, and the condensate is collected by the internal drip tray under the condenser and is then removed through the hose connected to the drain.

Additionally, on the rear wall of the condensate hood there is the spiral hose connected to the combi steamer fume extraction. That pipe is always in the state of slightly negative pressure (during the hood operation) and collects vapours from the combi steamer.

### Appliance Preparation

1. Before use, clean the appliance, observing instructions in section 6 “**Cleaning**”.
2. Dry the appliance thoroughly.

EN

### Control Elements

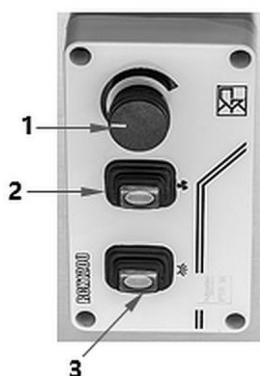

1. Motor speed rotary control knob
2. ON/OFF switch
3. Lighting button (inactive)

Fig. 7



### Appliance Operation

1. Connect the extractor hood to the power supply.
2. Switch the appliance on with the installed disconnecter.
3. If necessary, start the appliance by pressing the ON/OFF switch.

The appliance starts with minimum speed.

Vapours are vented during preparation of food and exhausted through the exhaust air installation.

4. Set the required motor speed.

The motor speed is controlled steplessly with the use of a motor speed rotary control knob.

5. Rotate the controller clockwise to increase speed or anti-clockwise to reduce it.

### Switching Appliance OFF

1. When the appliance is not to be used any more, it should be switched off with the ON/OFF switch.
2. Disconnect the appliance from the power supply using the factory-installed main switch.

EN

## 6 Cleaning and Maintenance

The operator must ensure that the device and its safety components are kept in good condition. Control and safety systems should be checked for their effectiveness.

Maintenance, cleaning and repairs must only be carried out by suitably trained and specialised personnel.

If the safety devices need to be removed for maintenance, cleaning and repair, they should be reinstalled immediately after completion and their function should be checked.

All maintenance and cleaning work must be carried out in accordance with the operating instructions at the specified intervals.

### 6.1 Safety Instructions for Cleaning

- Before cleaning, disconnect the appliance from the power supply.
- Leave the appliance to cool down completely.
- Make sure water does not enter the appliance. Do not immerse the appliance in water or other liquids during cleaning. Do not clean the appliance with a pressurized water jet.
- Do not use any sharp or pointed, nor metal implements (knife, fork, etc.). Sharp or pointed implements may damage the appliance, and when in contact with live parts, they may cause electric shock.
- For cleaning, do not use any scouring agents that contain solvents nor corrosive cleaning agents. They may damage the surface.

### 6.2 Cleaning

#### Housing

1. Clean the appliance regularly.
2. Wipe the housing with a damp, soft cloth. Use mild cleaning agent if required.
3. For removing deposits, use plastic or wooden spatula.
4. Dry all cleaned surfaces thoroughly afterwards.

#### Filter

##### **WARNING!**

**Grease accumulation in the filter can cause a fire risk and malfunction of the extractor hood.**

Filters should be cleaned regularly.

With daily use of the extractor hood, filters must be cleaned at least once a week. For easier cleaning, filters can be pulled out.

1. Remove the filters (fig. below).

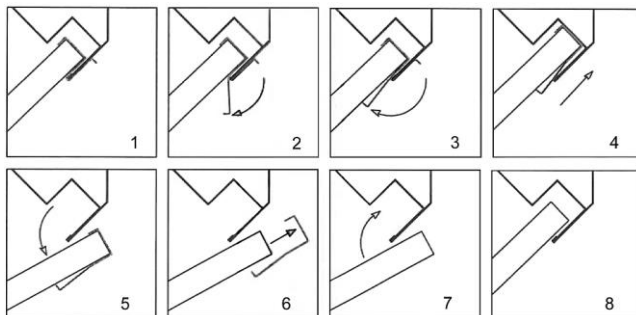

Fig. 8

2. Clean filters in a hot water bath with neutral detergent or in a dishwasher.
3. If needed, remove deposits using a soft brush for dish-washing.
4. Dry filters thoroughly.

Re-assemble in reverse order.

### Condenser

1. The condenser needs to be cleaned at regular intervals.
2. To remove the condenser, unscrew 4 retaining screws.
3. Clean the condenser with a neutral cleaning agent.
4. Clean the drip tray placed underneath with the use of a degreasing agent.
5. Pat dry the condenser and the drip tray.
6. To finish with, re-attach the removed elements.



Fig. 19

### 6.3 Maintenance

#### **ATTENTION!**

**All maintenance works with the appliance must be performed by qualified personnel only.**

To keep the appliance operational, it must be subject to maintenance at least twice a year. The maintenance includes:

- verification of the condition of wear-and-tear elements;
- verification of connections;
- verification of appliance operation.

During maintenance, worn elements should be replaced to avoid subsequent service works and sudden failures of the appliance.

Additionally, we recommend signing an agreement for performance of maintenance works with a trusted and proven service company.

EN

## 7 Disposal

### Electrical Appliance



Electric appliances are marked with this symbol. Electrical appliances must be disposed of and recycled in a correct and environmentally friendly manner. You must not dispose of electric appliances with household waste. Disconnect the appliance from the power supply and remove power cord from the appliance.

Electrical appliances should be returned to designated collection points.